

GRID headboard - wall mount

Please visit our website and watch the GRID video if you are unsure.

1

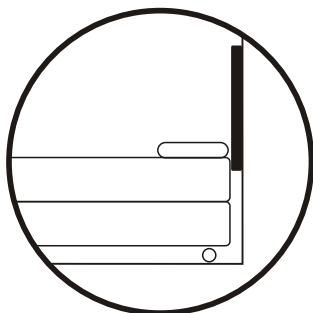

Work out the position of the headboard and bed. The bed should butt up to the headboard.

Centre and screw the wall rail into the timber framing. The wall rail should be 50mm below the top of the headboard. Make sure the wall rail is level and securely fixed. Use suitable wall anchors to fix the rail if there is no timber framing.

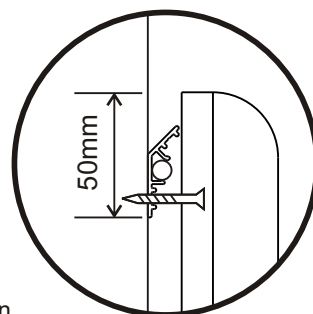

The wall rail may be in 2 sections for transportation. A rod is inserted between the 2 pieces to align the rails

2

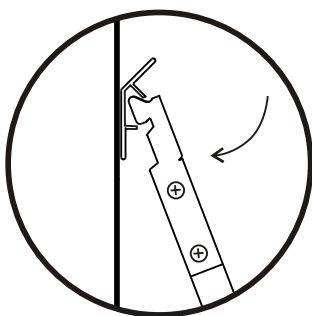

Insert the hangers into the wall rail. Position the hangers so the Hook & Loop aligns with the rear of the panels.

The hangers can be screw to the wall for larger headboards. There may be more hangers for different GRID designs.

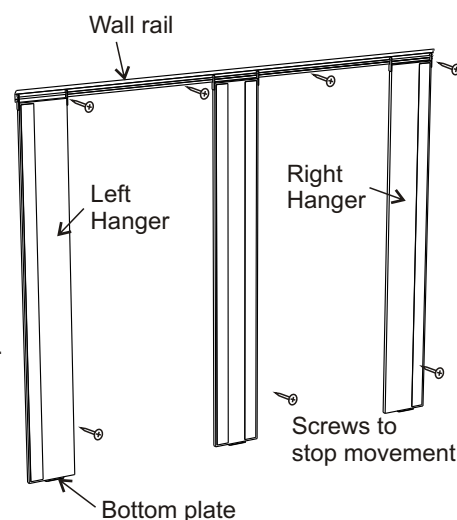

3

Attach the panels to the hangers, starting at the bottom. The bottom panels should sit on the bottom plates.

IMPORTANT! Make sure the hook and loop align with each other when fixing the panels to the hangers. Reposition the hangers if it does not align.

